

Insert the assembled retractable screen to the frame of your patio door, inserting the upper part first and then the bottom onto the existing track for the screen on your patio door.

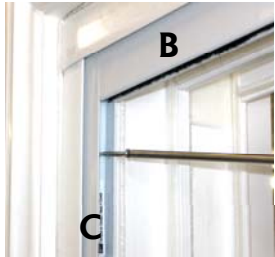

Attach your assembled retractable screen to the frame with two 1" (25.4mm) screws using the pre-drilled holes at the top and the bottom of the side extrusion (C).



Install the latch at the centre of the door with a 1" (25.4mm) screw, using the lower pre-drilled hole in the side extrusion (C).

## Step 6 Assembling the central handle

The two pieces of the handle have notches that must slide inside the groove.

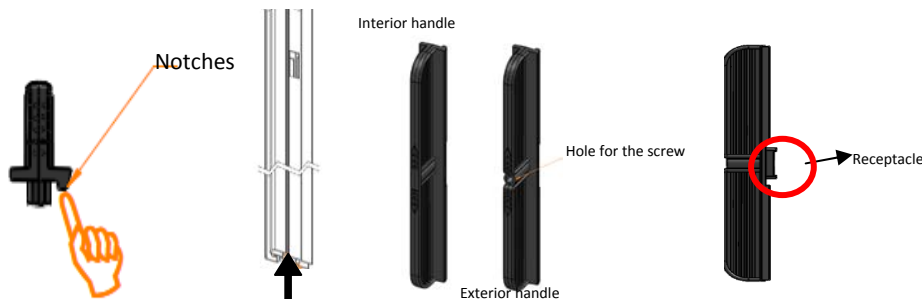

Install the interior handle, making sure that the receptacle is properly inserted into the mobile latch at the prescribed location.

Attach the exterior handle with a 1 3/4" (44.45mm) screw.

Be careful not to over-tighten the screw.  
The handle requires a certain amount of mobility up and down.



# Installation Guide Retractable screen Patio Door



NovaVision Inc.  
989 ave Bergeron  
St-Agapit, Québec Canada  
G0S 1Z0

Tel. : 418-888-5404  
1-877-888-5404  
Fax : 418-888-5411

[www.novavisionscreens.com](http://www.novavisionscreens.com)  
[info@novavisionscreens.com](mailto:info@novavisionscreens.com)

Please read the Installation Guide carefully and visit our  
Web site to watch the installation video.

**Install your new retractable Novascreen Patio Door screen on the same screen track that is currently on your patio door.**

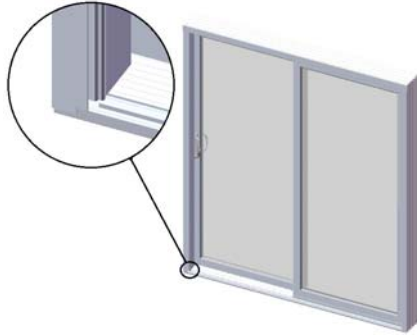

**If your door frame is not square, you will need to adjust your screen in order to install it properly.**

**Tools required to install your retractable patio door screen :**

- Screwdriver (star or square head)
- Tape measure
- Metal saw
- Utility knife
- Pliers

**In the box you'll find :**

- Retractable screen casing (A)
- 2 cross rails (B)
- 1 side extrusion (C)
- Installation Guide
- Bag of hardware
- Black central handle (in two parts)
- Extension for adjusting the height (D)
- 4 guides

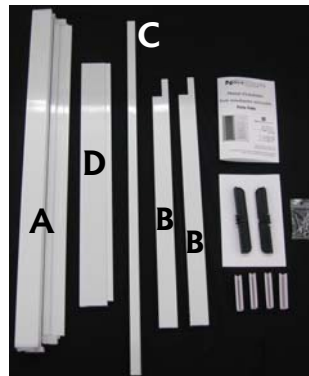

**The casing will be installed on the side of the fixed panel, at the centre of your door.**

**This screen can be installed on the left or the right.**

**Next, use the utility knife to cut the height adjustment extension (D) along the grooves provided for this purpose. Run the knife along the grooves 3 times on each side. Remove the excess material with the pliers.**

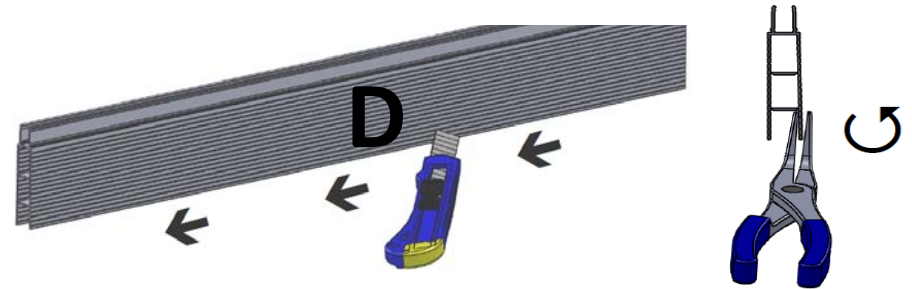

**You will need to cut your height adjustment extension (D) to the same width as your assembled retractable screen framing.**

**Important : cut on the opposite side to the notch as it must be kept for inserting the side extrusion (C).**

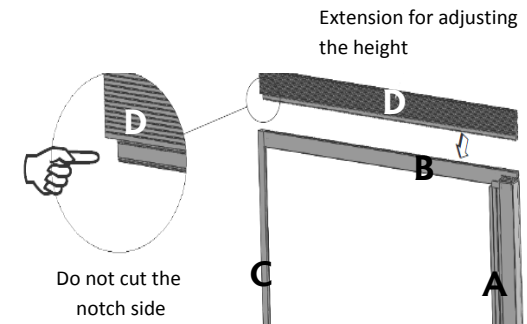

**Press the height adjustment extrusion (D) firmly into the top rail (B).**

## **Step 5 Installation of the screen on the patio door**

**Install the four guides on the inside of the rails :**  
**1 at the top (at the end of the casing side)**  
**3 at the bottom (1 at each end and 1 at the centre)**

**The longer side of the guide must be installed facing the outside of the door, to compensate for the slope of the sill.**

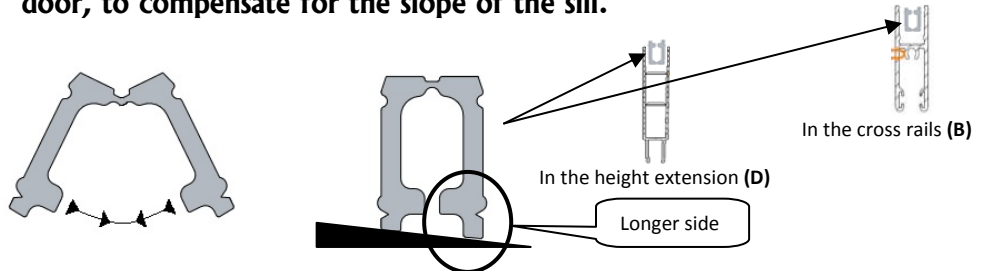

To determine the dimension of the height adjustment extension (D) take the dimension obtained from the top of the sill to the underside of the door frame and add  $\frac{1}{4}$ " (6.35mm), and then subtract  $77\frac{1}{4}$ " (1962mm). This will give you the dimension needed for the height adjustment extension (D).

**Example :** Dimension of the patio door : 78"(1981.2mm)  
 Add :  $\frac{1}{4}$ " (6.35mm)  
 Subtract :  $77\frac{1}{4}$ "(1962.15mm)  
 Result = Dimension of the extension = 1" (25.4mm)

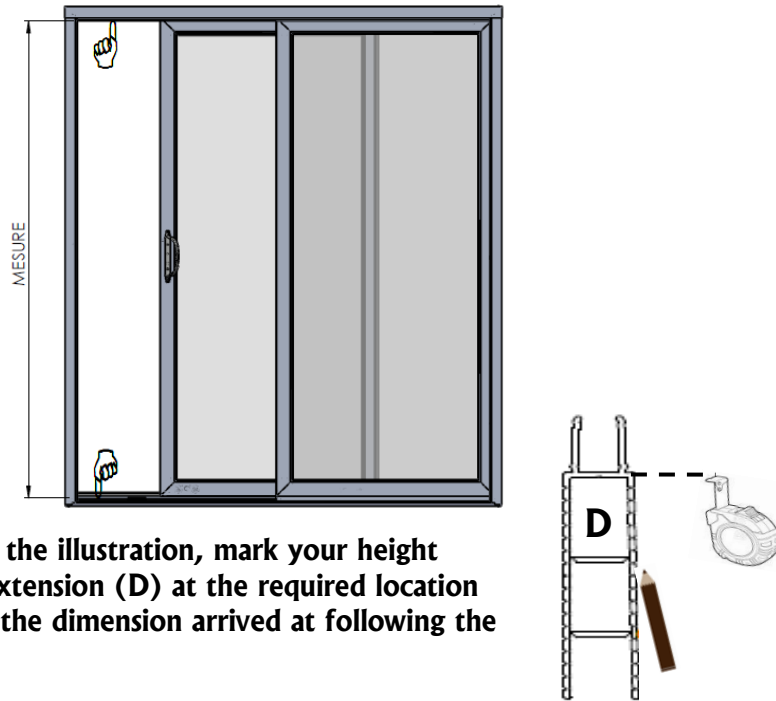

As shown on the illustration, mark your height adjustment extension (D) at the required location according to the dimension arrived at following the subtraction

Should the inside surface harmed when you cut the height adjustment extension (D), remove it with the pliers.

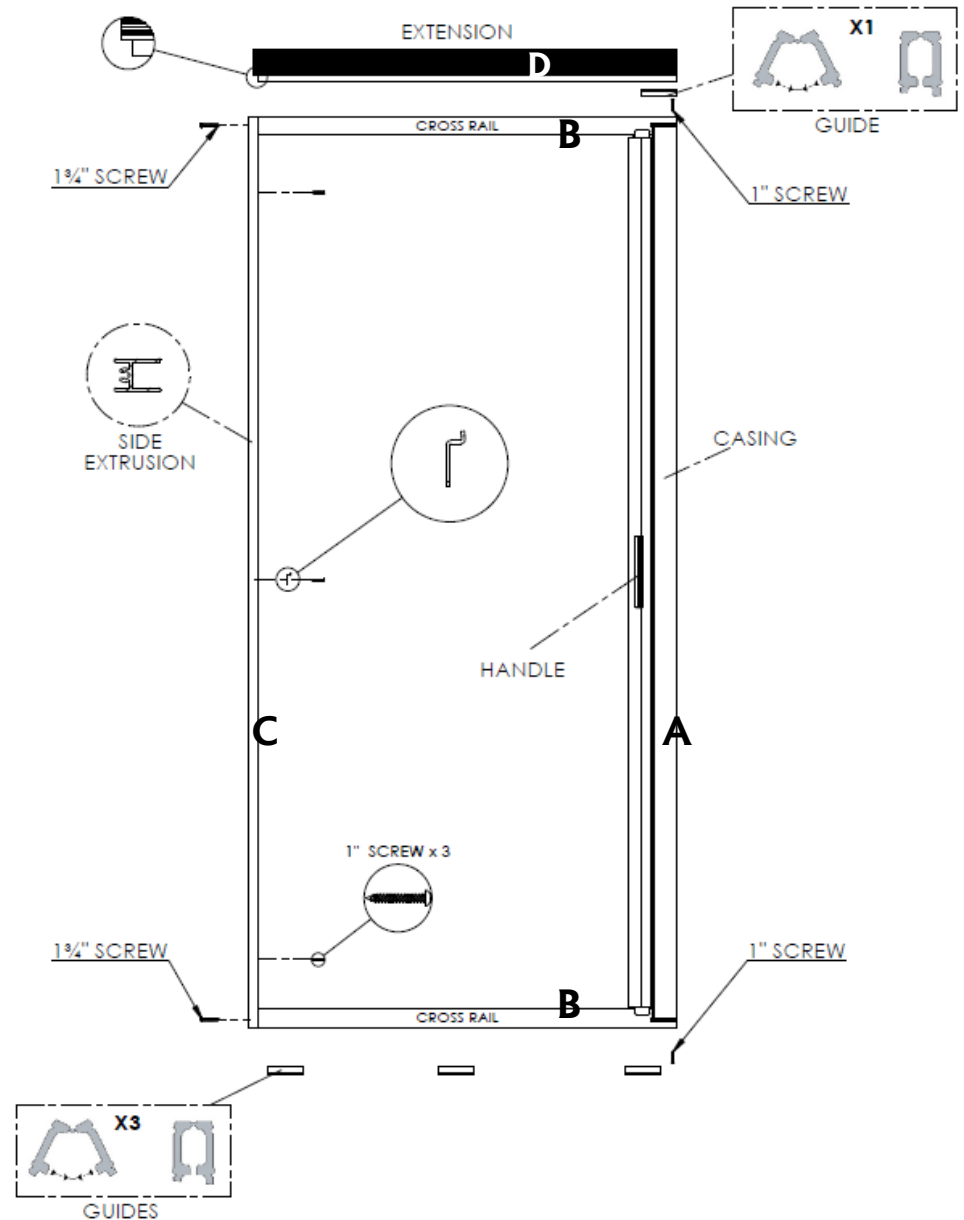
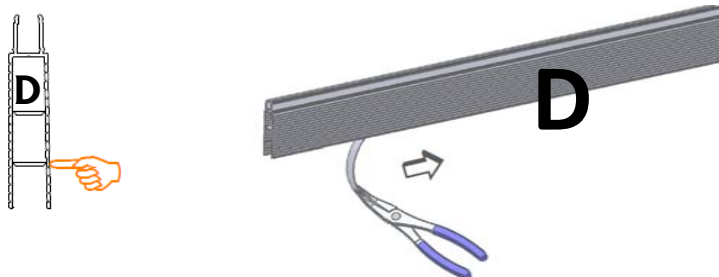

## Step 1 Measuring the width of the patio door

The cross rails (B) are designed for 6' (1828.8mm) wide patio doors.

Using the tape measure, determine the inside dimension of the opening where the screen will be installed, between the patio door frame and the fixed panel.

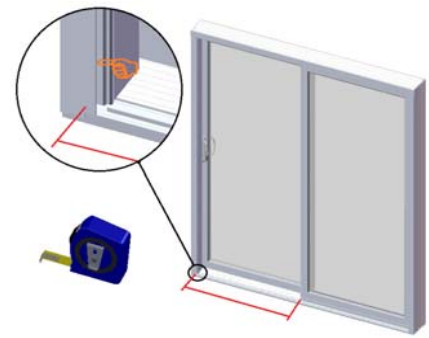

If the dimension of your opening is between 34" and 36" (863.6mm and 914.4mm), you do not need to cut the rails.

If not, add 1" (25.4mm) and then cut the two rails (B) on the ends without the notches. Keep the notches for the installation on the casing (A).

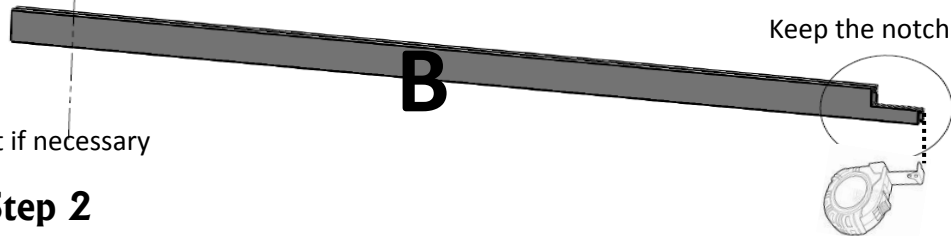

## Step 2 Assembling the patio door retractable screen

The notch on the rails (B) must overlap the casing (A).

Slide the rails (B) into the skaters making sure that the notch is perfectly positioned on the casing cap (A).

When sliding the rails (B), the rod on the casing cap (A) must fit into the round cavity inside the rail (B).

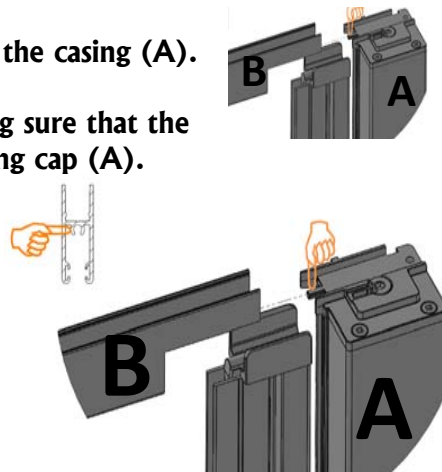

Attach the cross rails (B) to the casing (A) with 1" (25.4mm) screws using the pre-drilled holes at each end.



## Step 3 Attaching the side extrusion (C)

To complete the assembly of the framing for the retractable screen, install the side extrusion (C) with the deeper profile on the side extrusion (C) facing towards the inside of the retractable screen framing.

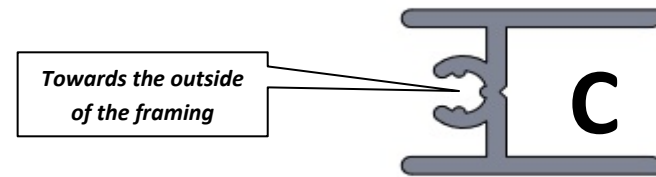

Fix it in place with two 1 3/4" (44.45 mm) screws using the pre-drilled holes.

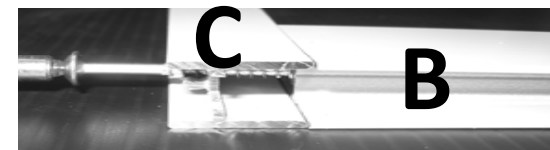

## Step 4 Installing the height adjustment extension (D) (if needed)

The framing that you have assembled for the retractable screen measures 77 1/4" (1962 mm) including the guides. If your door frame dimension (from the top of the sill to the underside of the header on your door frame) is greater than 77" (1956 mm) you will need to install the height adjustment extension (D) in the top rail, to fill the empty space. If not, go to Step 5.